

➤ **NetBox IP65 OutDoor Wall Cabinet 15U (WxD) 600mm x 400mm**

**Part Number: NB-CAB-200**



**General Description**

- **NetBox** provide strong and stable framework of cabinets, which has mounting holes.
- The side panel and rear panel are the double-panel designed, the panels are fixed by the bolt from the inner.
- Between the inside and outside panel has the inter space which provides channel to ventilate and support the enclosure internal heat exchange and also can reduce the influence of the sunlight illumination.
- The roof panel has the awning all around stretches out to keep from the rain, the bottom of awning have holes to keep the integrity well ventilated, which guarantees the air exchange.
- The bottom have cable entrance with rubber ring.
- The enclosure is the 19" structure, and can install wall mounted.
- The top loaded with fans to ventilate, two sides panels have the blind holes to output heat.

## **Features:**

- 767mm(H) X 600mm (W) x 400mm (D)
- 2.0mm thickness
- IP65 (Dust Tight, Waterproof)
- Gray RAL7035SN
- Comply with IEC60950-1, IEC6029 & GB4208-93 Standards.

## **Accessories:**

- 4 Pcs Hooks
- 2 Pcs Fans with Power Line
- 15 Sets Cage & Nuts

## ➤ NetBox 9U, OutDoor, Wall Mount Cabinet, IP66

### SPECIFICATION

Items	Specifications	Notes
Storage temperature	-40℃~+70℃	
Internal dimensions (H x W x D)	9UH*19inchW*550D	
Maximum external dimensions (H x W x D)	500mm*600mm*600mm	Including the base and the protruding part of the door/ plywood packaging
material	aluminum galvanised steel sheet SPCC	PU sandwich panel 45 mm thickness
Base dimensions (H x W x D)	50mm*600mm*600mm	
Weight	About 80KG	
Wind resistance	45m/s	
Solar radiation	≤1120W/m2	
Altitude	<4000m	
Atmospheric pressure	70kPa~106kPa	
Anti-corrosion performance	≥ 240 hours of a salt spray test	Test method: IEC 60068-2-52
Fireproof performance	Level B requirements in EN13501-1:2002	
IP level	IP66	
Transportation mode	Hoisted as a whole, transported as a whole, and moved using a pallet truck	
Maintenance mode	Maintained from the front/top/back	
Service life	15-18 years	
Noise	≤ 65 dB(A)	Acoustic pressure level, GR487 standard
Cabling mode	Routed from the bottom	
Wall board	Material: sandwich panel	Thermal conductivity: PU≤0.024(W/(m·k))
	Thickness: 45mm	EPS≤0.041(W/(m·k))
Shelter structure	The Mini-shelter is delivered as integrated equipment	

<u>SAMPLE IMAGE</u>	<u>TEST STANDARDS</u>
	<p>M/N : W-TEL-ACC W-TEL-FC, W-TEL-HXC, W-TEL-BC, W-TEL-EC, W-TEL-SC, W-TEL-DC, W-TEL-WC, W-TEL-FMC, W-TEL-IDC.</p> <p>Test Standard : EN60529:2000</p> <p>The EUT described above has been tested by us with the listed standards and found in compliance with the council LVD directive 2006/95/EC. It is possible to use IP marking to demonstrate the compliance with this LVD Directive. It is only valid in connection with the test report number: BCTC-12122581.</p> <p><b>IP66</b></p>

## ➤ IP66, OutDoor Cabinet

Items	Specifications	Notes
Storage temperature	-40℃~+70℃	
Dimensions (H x W x D)	15U*600mm*800mm	Including the base and the protruding part of the door
Base dimensions (H x W x D)	600mm*800mm*100mm	
Weight	About 220KG	
Wind resistance	45m/s	
Solar radiation	≤1120W/m <sup>2</sup>	
Altitude	<4000m	
Atmospheric pressure	70kPa~106kPa	
Anti-corrosion performance	≥ 240 hours of a salt spray test	Test method: IEC 60068-2-52
Fireproof performance	Level B requirements in EN13501-1:2002	
IP level	IP66	
Transportation mode	Hoisted as a whole, transported as a whole, and moved using a pallet truck	
Maintenance mode	Maintained from the front	
Service life	10 - 15 years	
Noise	≤ 65 dB(A)	Acoustic pressure level, GR487 standard
Cabling mode	Routed from the bottom	
Wall board	Material: SPCC galvanised steel Thickness: 2.0 mm	
Shelter structure	The Mini-shelter is delivered as integrated equipment and can be reassembled onsite.	

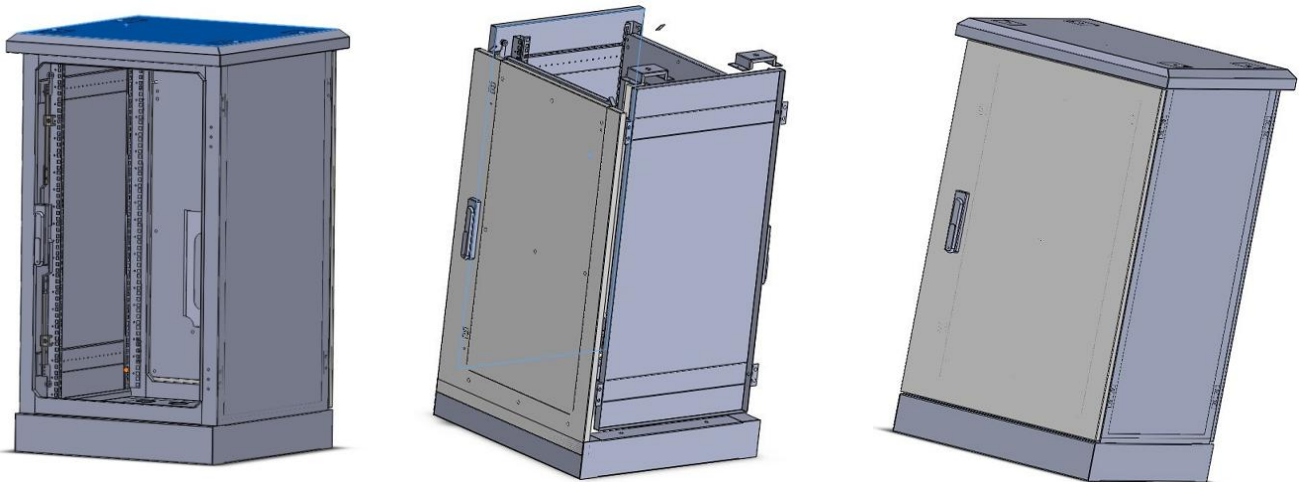

Sample Images

## ➤ NetBox 27U, OutDoor, Wall Mount Cabinet, IP66

### SPECIFICATION

Items	Specifications	Notes
Storage temperature	-40℃~+70℃	
Dimensions (H x W x D)	27U(H) x 600(W) x 600(D)	
Material	Aluminum galvanised steel sheet SPCC	PU sandwich panel 50 mm thickness
Base dimensions (H x W x D)	100*600*600	
Weight	230KG	
Wind resistance	45m/s	
Solar radiation	≤1120W/m <sup>2</sup>	
Altitude	<4000m	
Atmospheric pressure	70kPa~106kPa	
Anti-corrosion performance	≥ 240 hours of a salt spray test	Test method: IEC 60068-2-52
Fireproof performance	Level B requirements in EN13501-1:2002	
IP level	IP66	
Transportation mode	Hoisted as a whole, transported as a whole	
Maintenance mode	Maintained from the front/top/back	
Service life	15-18 years	
Noise	≤ 65 dB(A)	Acoustic pressure level, GR487 standard
Cabling mode	Routed from the bottom	
Wall board	Material: sandwich panel	Thermal conductivity: PU≤0.024(W/(m·k))
	Thickness: 50mm	EPS≤0.041(W/(m·k))
Shelter structure	The Mini-shelter is delivered as integrated equipment	

### TEST STANDARDS

M/N : W-TEL-ACC  
W-TEL-FC, W-TEL-HXC, W-TEL-BC, W-TEL-EC,  
W-TEL-SC, W-TEL-DC, W-TEL-WC, W-TEL-FMC, W-TEL-IDC.

Test Standard : EN60529:2000

The EUT described above has been tested by us with the listed standards and found in compliance with the council LVD directive 2006/95/EC. It is possible to use IP marking to demonstrate the compliance with this LVD Directive. It is only valid in connection with the test report number: BCTC-12122581.

**IP66**

## PRODUCT IMAGE



NB-CAB-185

NetBox Outdoor Cabinet, Freestanding, 27U, 600\*600, IP66



## NetBox Outdoor Cabinet (*with Cooling*)

### SPECIFICATIONS

1. Cabinet internal dimension : 25U\*19inch\*600  
Cabinet external dimension : 1400\*600\*650
2. Cabinet with PU sandwich panel 50mm thickness  
Cabinet with RAL 7035 power coated EMC protection  
Cabinet with SPCC galvanised steel sheet panel  
Cabinet with double roof/paper file door/plinth/earthing system/lifting ring/front & back door



Sample Images

Items	Specifications	Notes
Storage temperature	-40°C~+70°C	
Internal dimensions (H x W x D)	25U*19inch*600	
Maximum external dimensions (H x W x D)	1400*600*650	Including the base and the protruding part of the door/Carton packaging
Material	Aluminum galvanized steel sheet SPCC	PU sandwich panel 50mm thickness
Weight	About 150 KG	Including the weight of air-con
Anti-corrosion performance	≥ 240 hours of a salt spray test	Test method: IEC 60068-2-52
Transportation mode	Hoisted as a whole, transported as a whole, and moved using a pallet truck	
Maintenance mode	Maintained from the front/top/back	
Cabling mode	Routed from the bottom	
Air-Con	Wall Mount (side mount)	UL Smart type

## DRAWING

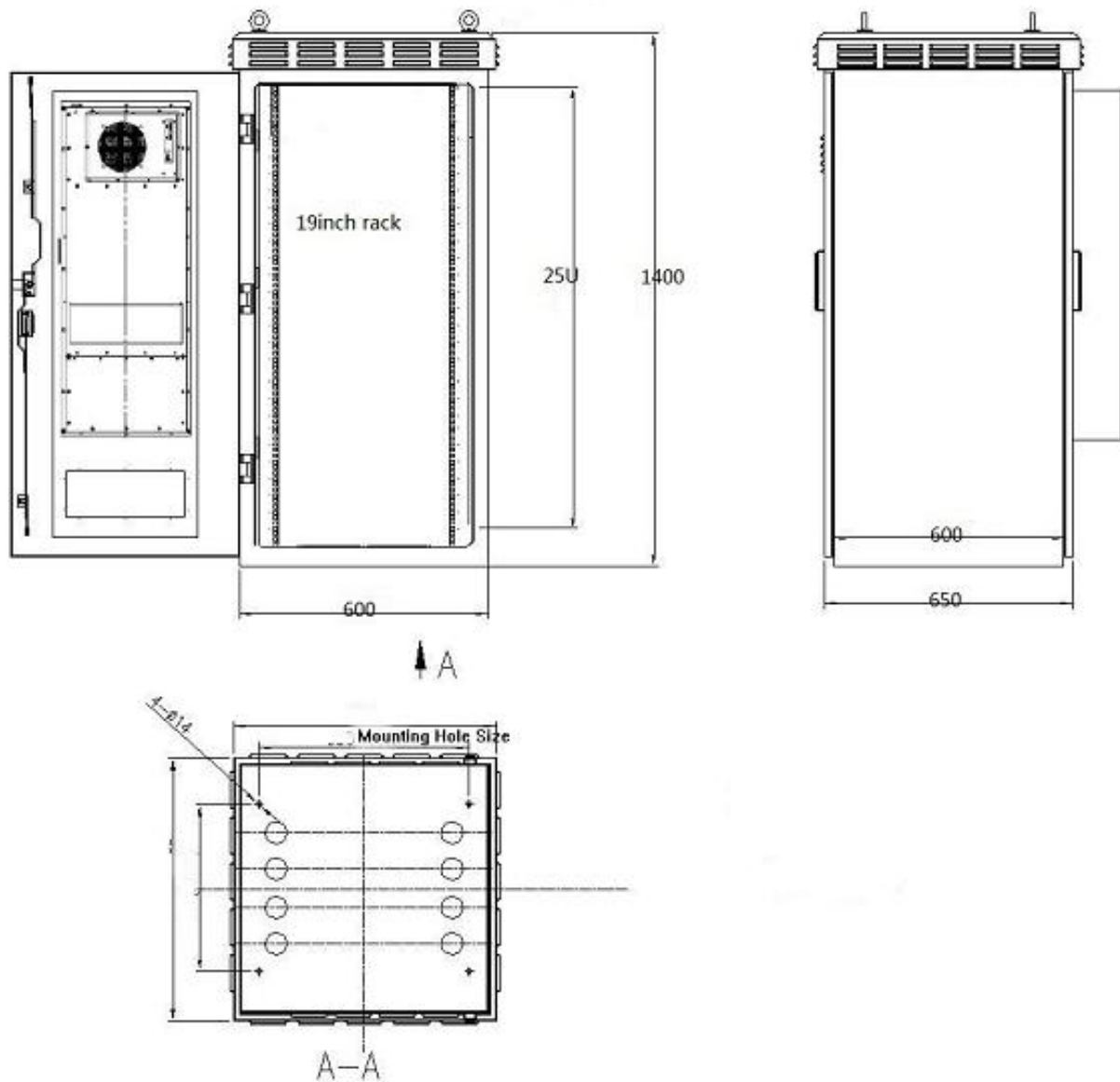
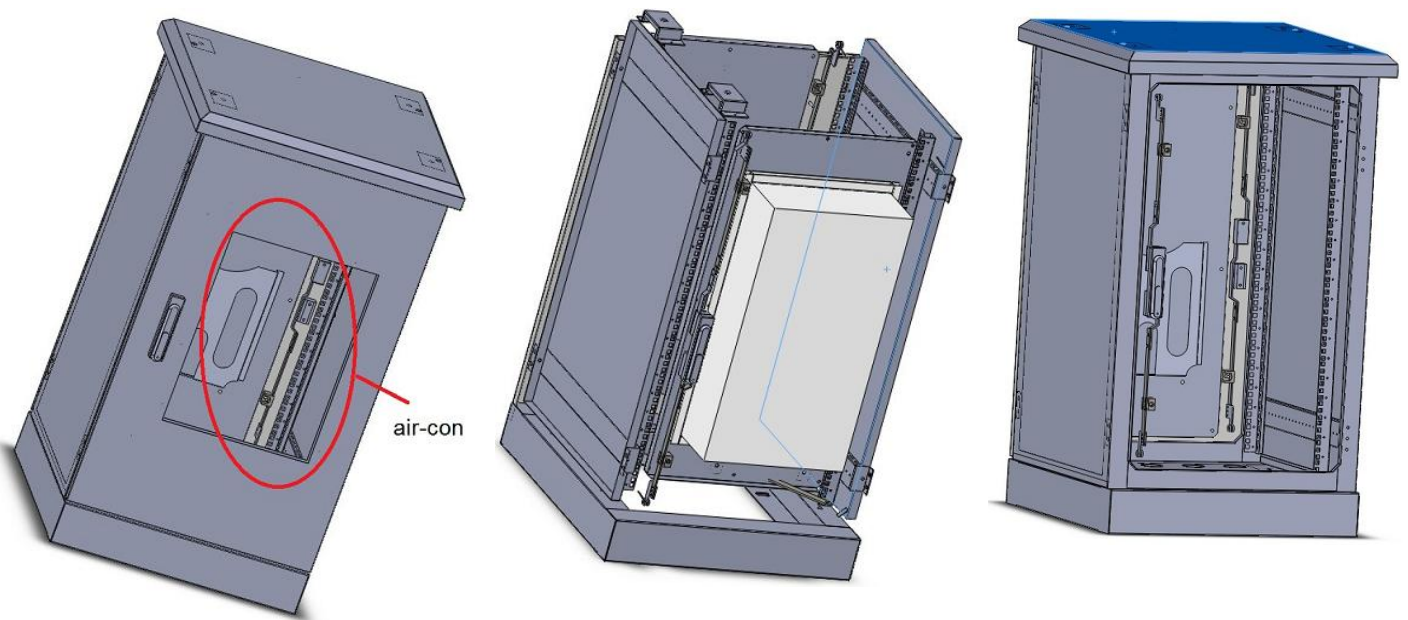



## TECHNICAL DATA

### AIR CONDITONER 500

<b>Item Number</b>		
<b>Cooling capacity &amp; power</b>		
Cooling capacity	W	500
Power	W	220
Input voltage range	V AC	220 ± 10% /50Hz±5%
Current	A	1.0
<b>Dimensions, weight&amp; mounting</b>		
External unit dimensions including the flange (length×width×height)	mm	550×320×175
Net weight	Kg	19
Type		Indoor
Mounting method		Through wall/door
Controller location		Built into the unit
<b>Environment protection &amp; performance</b>		
Working temperature range	°C	-15 ~ +55
Storage temperature range	°C	-40 ~ +70
Storage relative humidity	RH	5~95%
Noise level (outside 1m distance at 35°C internal and 35°C ambient)	dB	60
Refrigerant		R134a
Colour	RAL	7035

## DIMENSIONS

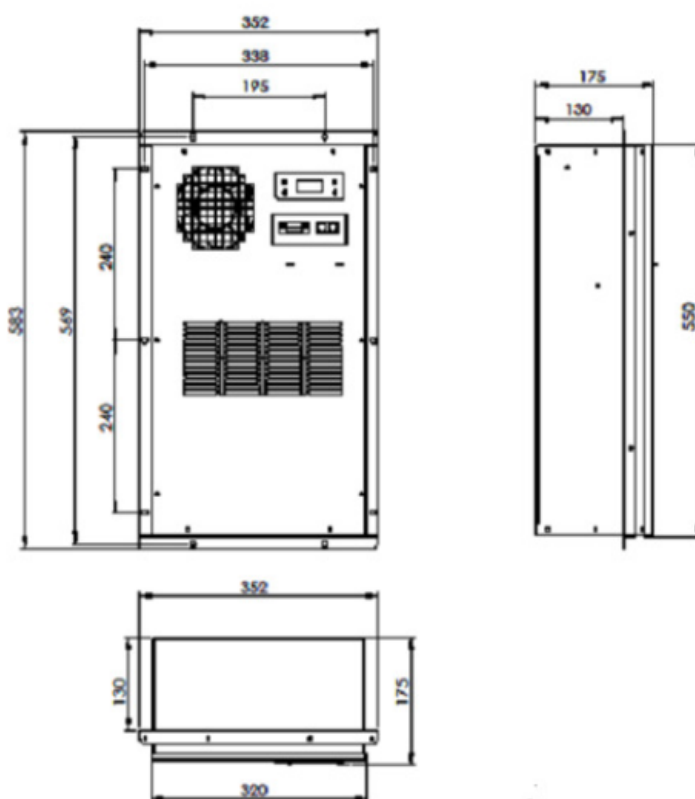

## ➤ NetBox 42U, 800x800 Cabinet, IP55

Features	Specifications	Notes
Storage temperature	-40℃～+70℃	
Internal dimensions (H x W x D)	42U H*800W*800D	
Maximum external dimensions (H x W x D)	2000mm*900mm*900mm	Including the base and the protruding part of the door/plywood packaging
material	Aluminum Galvanized Steel Sheet SPCC	2.0mm thickness black color power coated EMC protection
Base dimensions (H x W x D)	100mm*900mm*900mm	
Weight	About 110KG	Including the package
Wind resistance	45m/s	
Solar radiation	≤1120W/m <sup>2</sup>	
Altitude	<4000m	
Atmospheric pressure	70kPa～106kPa	
Anti-corrosion performance	≥ 240 hours of a salt spray test	Test method: IEC 60068-2-52
Fireproof performance	Level B requirements in EN13501-1:2002	
IP level	IP55	
Maintenance mode	Maintained from the front/top/back	
Service life	15-18 years	
Noise	≤ 65 dB(A)	Acoustic pressure level, GR487 standard
Cabling mode	Routed from the bottom	
Wall board	Material: Galvanized SPCC	Thermal conductivity: PU≤0.024(W/(m·k))
	Thickness: 2.0mm	EPS≤0.041(W/(m·k))
Transportation mode	Hoisted as a whole, transported as a whole, and moved using a pallet truck	

## PRODUCT REFERENCE IMAGES

*(These images are purely for reference purposes)*

